

OPERATOR'S & PARTS MANUAL

PC - SERIES PARA-LEVEL COMPACT

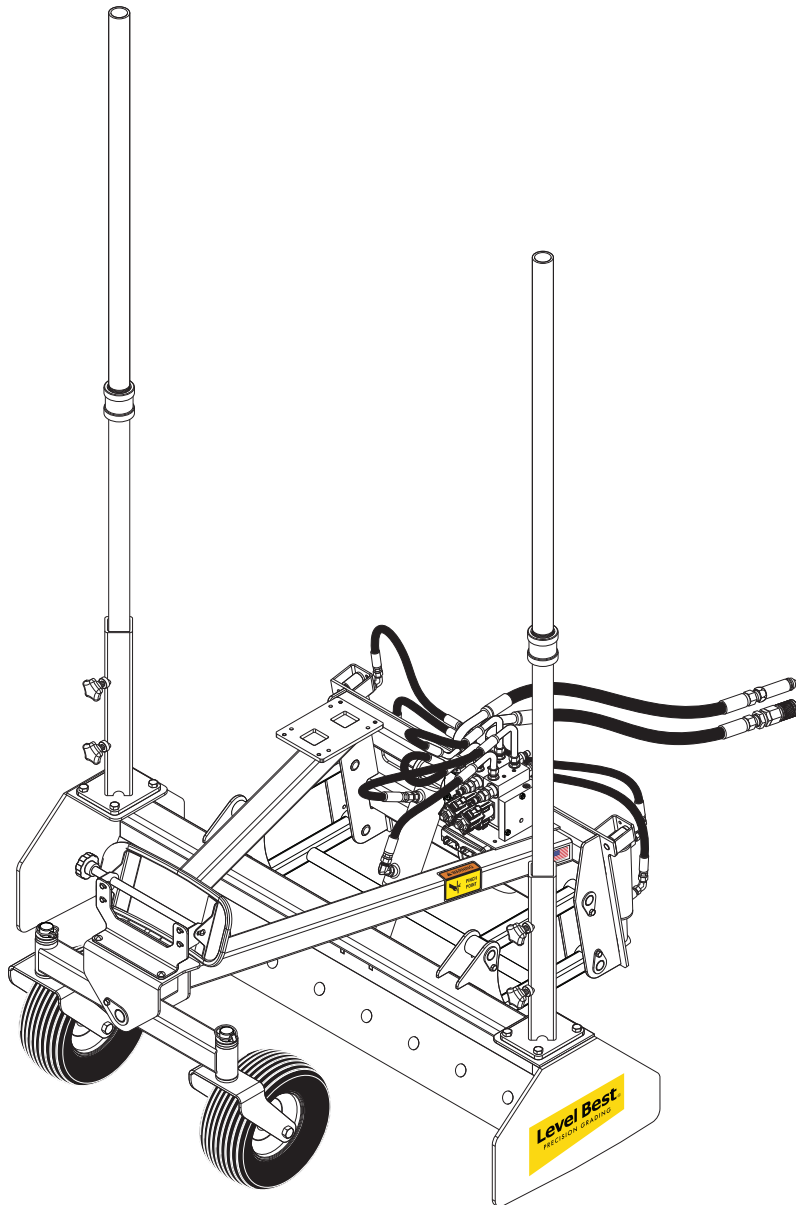

ATI Group, LLC.
New Holland, PA 17557
1-800-342-0905
www.LevelBestGrading.com

MAY 2024

CAT.#LBPLD-PC-OM&PM 05/01/24

COPYRIGHT 2024 by
ATI Group, LLC.
250 Earland Drive
New Holland, PA 17557 U.S.A.

DISCLAIMER

THE INFORMATION IN THIS MANUAL IS PROVIDED TO PROMOTE THE SAFE USE OF, AND ASSIST THE OPERATOR IN ACHIEVING THE BEST PERFORMANCE FROM, PARA-LEVEL GRADING BOX DESCRIBED HEREIN, FOR THEIR INTENDED APPLICATIONS.

USING THIS DOCUMENT

This document is expected to be used as an electronic pdf document as well as a printed document. Various software can be used to view the document, including [Adobe® Acrobat Reader DC](#). Other pdf viewers are available.

As an electronic document, various links are included to help you navigate the document and find the applicable information. Links may be cross references within the document or an external link to an Internet page. Links shown in blue, such as the link to the Acrobat Reader DC software in the preceding paragraph. For an Internet link to work, the device must be connected to the Internet in some way. Data charges may apply.

NOTE: Most pdf viewer software provides a command for previous view. In Acrobat Reader, for instance, the previous view on the View/Page Navigation menu. Keyboard shortcuts are also available, such as Alt+Left Arrow and Alt+Right Arrow for Previous View and Next View, respectively.

WARRANTY

This Level Best Grading System is designed and manufactured to high standards. ATI Group, LLC., therefore, guarantees this Level Best product to be free from defect in workmanship and materials for three (3) years from purchase date. If the machine is to be used for rental purposes the warranty is limited to ninety (90) days.

Components supplied by outside vendors (e.g. cylinders, hydraulic valves and components, electronic modules, and machine control technology systems) are warranted separately by their respective manufacturers. The warranty periods of these components are generally one (1) year from date of purchase.

Neither Level Best nor hydraulic component manufacturers will cover normal wear or failure due to hydraulic oil contamination from the power source. ALWAYS start with clean oil and filters prior to installation and operation.

Misuse, abuse, misapplication, and un-authorized alterations will void this warranty.

All warranty work must be performed by an authorized Level Best dealer and authorized by ATI Group, LLC. All Level Best parts suspected of failure must be returned to ATI Group, LLC., for warranty analysis prior to any credit being issued.

TABLE OF CONTENTS

Disclaimer.....	i
Using This Document.....	i
Warranty.....	ii
Table of Contents.....	iii
List of Illustrations.....	iv
Safety Information.....	v
Systems Features And Basic Operation.....	1.1
Specifications and Maintenance	2.1
Troubleshooting.....	3.1
Parts Illustrations	4.1
Serial Number Information.....	4.2
Where To Get Parts And Service	4.2
How To Order Parts	4.2
List of Parts Illustrations.....	4.3
Index	5.1

LIST OF ILLUSTRATIONS

Figure 1-1.	Optional Joystick.....	1.1
Figure 1-2.	Joystick Functions.....	1.1
Figure 2-1.	Hydraulic Valve (Danfoss MVB10).....	2.2
Figure 2-2.	Valve Cable Connections	2.2
Figure 4-1.	Main Frame and Cutting Edges.....	4.4
Figure 4-2.	Attachment Frame and Related Parts	4.6
Figure 4-3.	Caster Fork and Wheel.....	4.8
Figure 4-4.	Hydraulic Valve, Lift Cylinder & Related Parts.....	4.10
Figure 4-5.	Hydraulic Valve, Tilt Cylinder & Related Parts	4.12
Figure 4-6.	Hydraulic Valve Assembly	4.14
Figure 4-7.	Decals	4.16

SAFETY INFORMATION

This manual is furnished to you, the owner/operator, as a guide to get the greatest benefit from your grading box. ATI Group, LLC., wants you to be able to get the most use out of your grading box through safe and efficient operation.

Before attempting to operate the grading box, carefully read all sections of this manual. Be sure that you thoroughly understand all of the safety information and operating procedures.

SAFETY PRECAUTION DEFINITIONS

Dangers, Warnings, Cautions, and Notes are strategically placed throughout this manual to further emphasize the importance of personal safety, qualifications of operating personnel, and proper use of the grading box in its intended application. These precautions supplement and/or complement the safety information decals affixed to the unit and include headings that are defined as follows:

DANGER

Indicates an imminently hazardous situation which, if not avoided, will result in death or serious injury.

WARNING

Indicates a potentially hazardous situation or practice which, if not avoided, could result in death or serious injury.

CAUTION

Indicates a potentially hazardous situation or practice which, if not avoided, will result in damage to equipment and/or minor injury.

NOTE: Indicates an operating procedure, practice, etc., or portion thereof, which is essential to highlight.

- Always use caution and safe operating practices when operating this equipment.
- Always set the Automatic/Manual Switch on the Control Panel to MANUAL before leaving the operator's seat or whenever the machine is not moving.

- Always allow for clearance under the cutting edge of the machine when tuning the system or when switching to automatic control. Insufficient clearance could cause the machine to lift itself off the ground as its cutting edge attempts to achieve the programmed slope.
- Never adjust the position of the laser receiver when the system is in automatic control.
- Never perform service work on your machine or the Automatic Control System when the system is in automatic control.
- Install all safety panels and guards before operating your equipment.
- Stay clear of all moving parts when the machine is in operation.
- Keep all people clear of the machine when it is running.
- Keep feet and other body parts from under the cutting edges of the machine at all times.
- Read and comply with all safety recommendations of your tractor/skid steer manufacturer, as outlined in its operator and service manuals.

NOTE: References made to left, right, front, and rear are those directions viewed from behind the power unit and grading box.

NOTE: Some equipment depicted in illustrations may not reflect exact production model configurations.

NOTE: All safety, operating, and servicing information reflects current production models at the time of publication of this manual.

NOTE: ATI Group, LLC., reserves the right to discontinue models at any time, change specifications, and improve design without notice and without incurring obligation on goods previously purchased and to discontinue supplying any part listed, when the demand does not warrant production.

(for future use)

SYSTEMS FEATURES AND BASIC OPERATION

OVERVIEW

The Level Best grading box is a cost-efficient method for fine grading. Various capacities sized to fit all sizes of mini track loaders (MTL) with a choice of automatic control systems are available.

A typical 2D system provides laser-guided depth control along a plane from a single reference point which must be set up for each job site. A 3D system adds locating ability to the control through either a satellite constellation (GPS) or local positioning system (LPS). The control system not only knows the desired depth on the plane, but the location of the machine on the job site and, in the case of a GPS system, even which job site you are currently on.

The desired blade depth is processed and automatically controls the grading box's hydraulics to maintain the elevation of the cutting edge based on the site plan.

OPERATION

Operation of the grading box and automatic control system is typically in automatic mode. Manual override and fine tuning are available through a mounted joystick control on the MTL.

This CAN joystick provides full override capabilities of the grading box as well as interfaces with the control system to switch Auto/Manual mode and correct grade offset (Increment/Decrement).

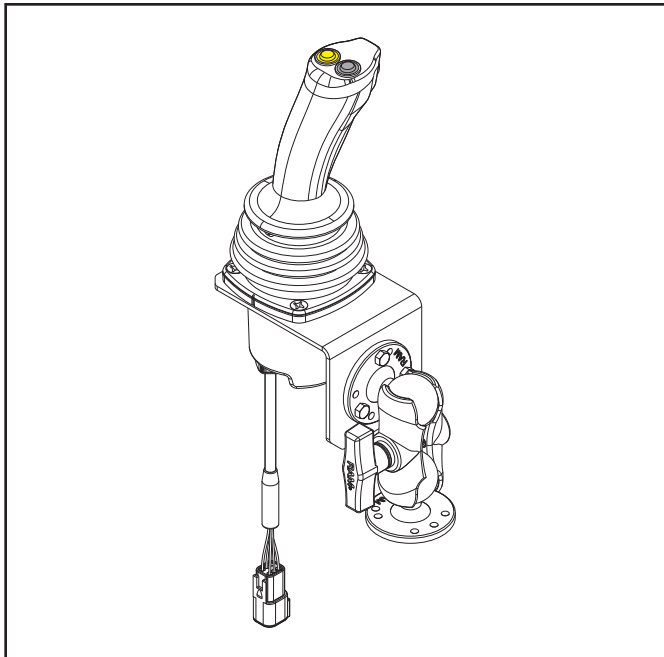

Figure 1-1. Optional Joystick

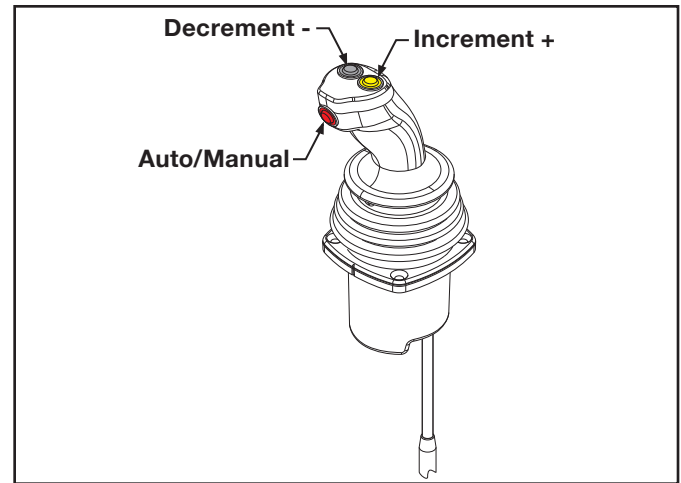

Figure 1-2. Joystick Functions

SYSTEMS FEATURES AND BASIC OPERATION

(for future use)

SPECIFICATIONS AND MAINTENANCE

SPECIFICATIONS

Dimensions

Model	PC-48	PC-60
Cutting Width	48 in. (122 cm)	60 in. (152 cm)
Overall Width	49 in. (125 cm)	61 in. (155 cm)
Total Length	52 in. (132 cm)	
Weight	580 lbs. (263 kg)	640 lbs. (290 kg)

PC Series Hydraulic Valve

Valve Type	Danfoss MVB10 Proportioned
Minimal Flow Rate	10 GPM (37.8 LPM)
Maximum Hydraulic Pressure	4060 psi (280 bar)

MAINTENANCE

The rugged and durable Level Best grading box is built to last, but as with all equipment, a few minutes of routine care, maintenance, and cleaning can extend the life of the system.

Storage and Transport

Most often the grading box and its hydraulic controls remain on the machine. However, the Automatic Control System components should be stored in a safe, protected place when not in use. Protect the cable connections by installing the covers supplied.

Cleaning

The Control Panel is water-resistant. It can be cleaned with mild soap, water, and a damp, soft cloth. Do not submerge the Control Panel or direct high pressure spray at it. Do not use a dry cloth to wipe the laser receiver or Control Panel as scratching may occur.

Cables and Hoses

Check all cables and hoses regularly for signs of wear and damage. Keep cable connections clean and free from dirt and corrosion. If a cable has been damaged, do not attempt to repair. Incorrect or poor connections can cause damage to your Automatic Control System.

When applicable, check the hydraulic hoses. Look for areas where the hoses could rub against each other or another object as they expand and contract under pressure. Check the hydraulic fittings for tightness.

Machine

Check areas that affect the Automatic Control system function and accuracy, such as looseness or play in the cylinders or wear on the box's cutting edge. Looseness in the connection to the skid steer, such as in the adaptor plate, will cause inaccurate depth positioning.

Also check the skid steer routinely for wear to its components, such as loader pins and quick-attach linkage, ensuring it is operating properly.

Loader Hydraulics

Change the oil and filter per loader manufacturer recommendations to ensure proper function of your Level Best grading box.

SERVICE

If the Automatic Control System is not functioning properly, the first step is to determine the problem component. Use the Troubleshooting Chart to determine possible causes and remedies. The following test equipment is needed:

- Voltage/Ohm Meter
- Rotating Laser or Laser Simulator

Cable Wiring Diagrams and troubleshoot electrical problems contact your local Machine Control Dealer.

HYDRAULICS

Danfoss MVB10 Hydraulic Valve

The hydraulic valve is setup at the factory and should not need any adjustments. If there are any changes required, they should be done by an authorized factory technician.

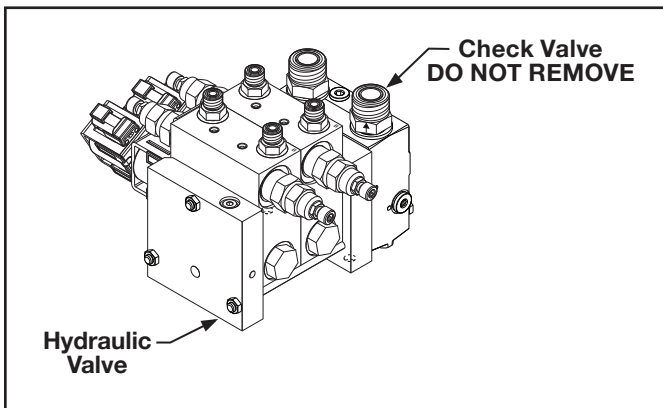

Figure 2-1. Hydraulic Valve (Danfoss MVB10)

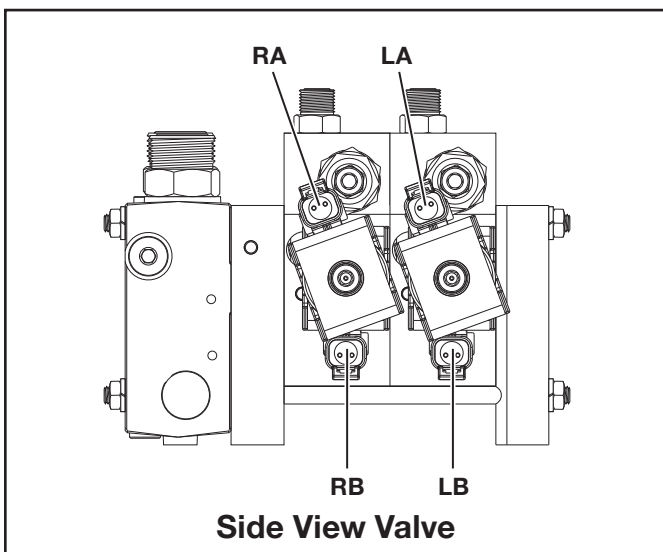

Figure 2-2. Valve Cable Connections

TROUBLESHOOTING

SYMPTOM	POTENTIAL CAUSE	REMEDY
Grading box has trouble staying on grade.	Rotating laser out of range.	Ensure laser receiver is within specified range of rotating laser.
	Laser beam being reflected.	Ensure rotating laser's light is not reflecting off outer surfaces (windows, windshields, mirrors, etc.) causing multiple readings by the laser receivers.
	Multiple laser beams.	Ensure that there are no other lasers operating on the job site or nearby.
	Laser deadband set too narrow.	Ensure the deadband (accuracy) setting is appropriate for rough grading.
	Travel speed is too fast for grade tolerance.	Slow down.
	Hydraulic response too quick.	Decrease the valve speed setting.
Grading box doesn't return all the way to on grade.	Valve offsets need to be raised.	Call dealer.
Grading box keeps driving past on grade, and bouncing.	Valve offsets need to be lowered.	Call dealer.
Grading box doesn't follow receiver or control panel grade display.	Valve cables are connected to wrong sides.	Check to make sure the valve cable branches are hooked up properly. Elevation (left) branch of cable to the Elevation (left) Receptacle on the Valve, and Slope (right) branch of cable to the Slope (right) Receptacle on the Valve.

TROUBLESHOOTING

SYMPTOM	POTENTIAL CAUSE	REMEDY
Grading box does not raise or lower.	Control Panel not turned on.	Push the power switch.
	No hydraulic flow to grading box.	Ensure hydraulic control handle of skid steer is in correct position.
	Cables not connected correctly.	Ensure auxiliary hydraulics are on or in continuous flow mode. Check valve cable, valve and valve coils for visible damage.
	Electrical problems.	<div style="background-color: orange; text-align: center; padding: 5px;">⚠ WARNING</div> <p>Be sure to stay clear of any moving parts of the grading box.</p> <p>If the grading box moves, refer to Electrical problems. If the grading box does not move, refer to Hydraulic problems.</p> <p>Check valve cable, valve and valve coils for visible damage.</p> <p>Use an ohmmeter to check cable for continuity. Contact ATI Group, LLC., for pinouts.</p>
	Hydraulic problems.	<p>Confirm hydraulic flow through the manifold and returning to the power source through the “T” hose.</p> <p>Contact ATI Group, LLC., for help troubleshooting the hydraulic manifold.</p>
Grading box moves in unexpected/erratic direction.	Solenoid cable installed incorrectly.	Verify termination marked “Elevation” is installed in socket of elevation bank on Danfoss valve. Confirm respective termination on slope bank.

PARTS ILLUSTRATIONS

Parts Illustrations	4.1
Serial Number Information	4.2
Where To Get Parts And Service	4.2
How To Order Parts	4.2
List of Parts Illustrations	4.3

Serial Number Information

It is very important that the correct serial number is provided when ordering parts. The serial number plate is located on the main frame. Please mark the model and serial number of your Para-Level Grading Box in the space provided below in case the plate on your Para-Level Grading Box gets lost or damaged.

Model..... **Serial Number**

Dealer Name **Dealer Phone Number**

Where To Get Parts And Service

When replacement parts and service are required, ATI Group, LLC., recommends returning to the dealer from which the product or optional kit was purchased. By going to the dealer, you are dealing with people that understand and know ATI products. Our dealers have the experience servicing these machines and stock the most common parts required to keep your equipment in top working condition.

How To Order Parts

Parts lists contained in this book have been prepared to help you when ordering spare and/or replacement parts. Your order will be filled promptly and accurately when the following information is provided:

1. Model and serial number of the unit. (This specifically identifies the equipment you have and permits us to verify the part numbers in your order.)
2. The parts list page number and catalog number. Include catalog revision number, if applicable.
3. The **Item** number for each part. **Item** numbers on the parts list page correspond with the numbers shown on the illustration.
4. **Part Number** as it appears in the parts list. In most cases this will be a nine-digit number; for example: 315-005-000.
5. The **Description** for the part as it appears on the parts list page.

When a complete assembly is needed, use the assembly number given in the parts list. If no assembly number is given, order by main assembly title and list only the item numbers you want. For example: "Wheel Frame Assembly per 315-509-000, Items 2 through 8, inclusive".

The part ordered may have a new part number, or the part may have been replaced by a newer design with a different part number. In these cases your acknowledgement, shipping papers and invoices will be written listing the current part number first; the old part number you referred to will follow the part description.

Our purpose in doing this is to tell you that the parts are fully interchangeable. This will avoid any unnecessary correspondence or delay in processing your order. We suggest that you add any new number to your parts lists for future use.

NOTE: ATI Group, LLC., reserves the right to discontinue models at any time, change specifications, and improve design without notice and without incurring obligation on goods previously purchased and to discontinue supplying any part listed, when the demand does not warrant production.

LIST OF PARTS ILLUSTRATIONS

Figure 4-1.	Main Frame and Cutting Edges	4.4
Figure 4-2.	Attachment Frame and Related Parts	4.6
Figure 4-3.	Caster Fork and Wheel	4.8
Figure 4-4.	Hydraulic Valve, Lift Cylinder & Related Parts.....	4.10
Figure 4-5.	Hydraulic Valve, Tilt Cylinder & Related Parts	4.12
Figure 4-6.	Hydraulic Valve Assembly	4.14
Figure 4-7.	Decals	4.16

PARTS ILLUSTRATIONS

Figure 4-1. Main Frame and Cutting Edges

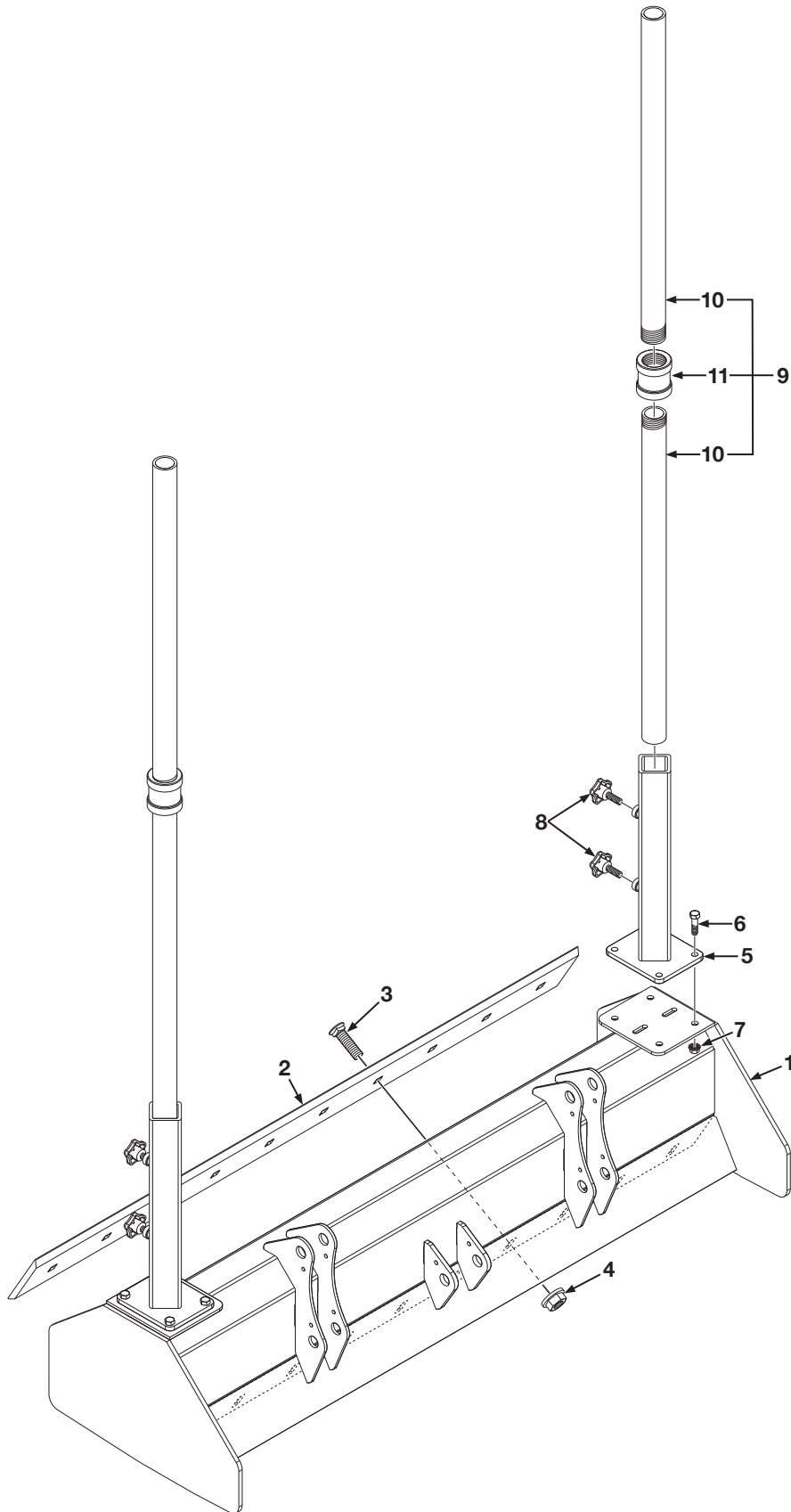

PARTS ILLUSTRATIONS

Figure 4-1. Main Frame and Cutting Edges

Item	Part No.	Qty	Description
1	314-001-100	1	Frame, Main, 48"
	314-002-100	1	Frame, Main, 60"
2	000-190-162	1	Edge, Cutting, DBF, 1/2" x 6" x 48" Long
	000-190-128	1	Edge, Cutting, DBF, 1/2" x 6" x 60" Long
3	000-150-258	AR	Bolt, Plow, 5/8"-11UNC x 1-3/4" Long
4	000-158-142	AR	Nut, Serrated Flange, 5/8"-11UNC
5	315-101-700	2	Mount, Mast Pole
6	000-150-396	8	Bolt, Serrated Flange, 1/2"-13UNC x 1" Long
7	000-158-111	8	Nut, Serrated Flange, 1/2"-13UNC
8	001-001-180	4	Handle, Star Knob, 1/2"-13UNC x 1-1/2" Long Thread
9	001-001-105	2	Pole, Mast, Sectional, 1-1/2" Dia. x 84" Long, Includes Items 10 & 11
10	001-001-106	4	
11	001-001-107	2	

AR - As Required NSS - Not Serviced Separately ASN - After Serial No. BSN - Before Serial No. LP - Local Purchase

PARTS ILLUSTRATIONS

Figure 4-2. Attachment Frame and Related Parts

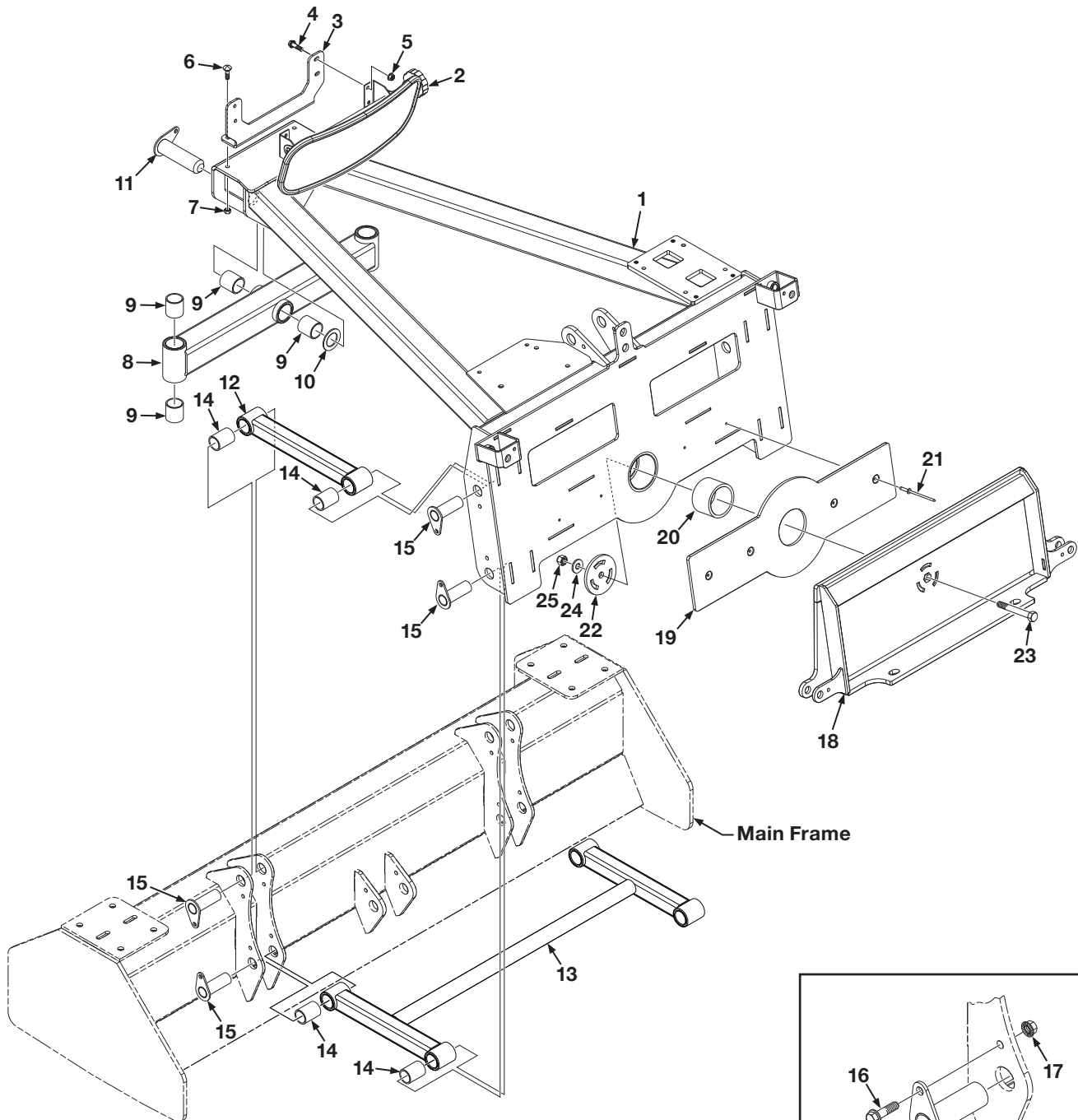

Typical Pivot and Link
Pins Installation

PARTS ILLUSTRATIONS

Figure 4-2. Attachment Frame and Related Parts

Item	Part No.	Qty	Description
1	314-001-100	1	Frame, Attachment
2	001-001-141	1	Mirror Assembly, Includes Items 3 thru 7
3	NSS	1	Bracket
4	000-150-046	4	Bolt, Serrated Flange, 1/4"-20UNC x 1/2" Long
5	000-158-048	4	Nut, Serrated Flange, 1/4"-20UNC
6	000-150-372	2	Bolt, Carriage, 5/16"-18UNC x 1" Long
7	000-158-064	2	Nut, Serrated Flange, 5/16"-18UNC
8	314-001-600	1	Axle Assembly, Front, Includes Item 9
9	000-176-177	6	Bushing, Wheel Frame, 1-1/2" OD x 1-1/4" ID x 1-1/2" Long
10	000-155-012	1	Spacer, Washer, 2" OD x 1-1/4" ID x 16 Ga. Thick
11	000-161-165	1	Pin, 1-1/4" Dia. x 4-5/8" Long
12	314-001-500	2	Link, Lift, Includes Item 14
13	314-001-400	1	Link, Lift, Torsion, Includes Item 14
14	000-176-174	8	Bushing, Link, 1-1/4" OD x 1" ID x 1" Long
15	000-161-226	8	Pin, 1" Dia. x 3-1/8" Long
16	000-150-074	11	Bolt, Serrated Flange, 5/16"-18UNC x 3/4" Long
17	000-158-223	11	Nut, Serrated Flange, Nylon Lock, 5/16"-18UNC
18	314-001-300	1	Frame, Tilt
19	314-001-230	1	Pad, Slide, Center Pivot
20	000-176-261	1	Bushing, 3" OD x 2-1/2" ID x 2" Long
21	000-161-237	4	Rivet, Steel, 3/16" Dia.
22	314-001-350	1	Pivot Cap, Center
23	000-150-207	1	Bolt, Hex Head, 1/2"-13UNC x 3-1/2" Long
24	000-155-056	1	Washer, Flat, 1/2" SAE
25	000-158-113	1	Nut, Hex, Nylon Lock, 1/2"-13UNC

AR - As Required NSS - Not Serviced Separately ASN - After Serial No. BSN - Before Serial No. LP - Local Purchase

PARTS ILLUSTRATIONS

Figure 4-3. Caster Fork and Wheel

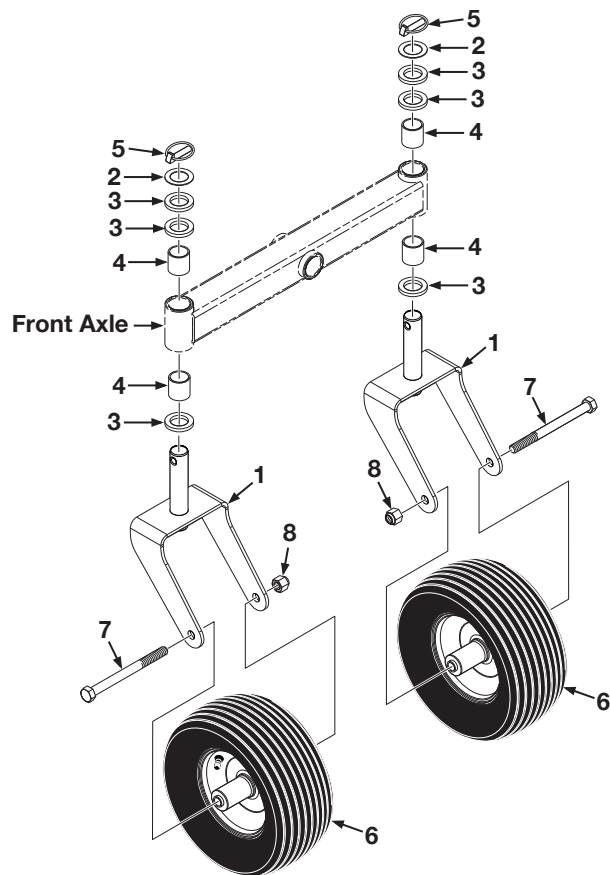

PARTS ILLUSTRATIONS

Figure 4-3. Caster Fork and Wheel

Item	Part No.	Qty	Description
1	314-007-700	2	Fork, Caster
2	000-155-012	2	Spacer, Washer, 2" OD x 1-1/4" ID x 16 Ga. Thick
3	314-001-610	6	Spacer, Washer, 2" OD x 1-1/4" ID x 1/4" Thick
4	000-176-177	4	Bushing, Wheel Frame, 1-1/2" OD x 1-1/4" ID x 1-1/2" Long
5	000-161-028	1	Pin, Lynch, Locking, 7/16"
6	001-001-100	2	Wheel/Tire, 13/6.50-6, White Wheel
7	000-150-284	2	Bolt, Hex Head, 5/8"-11UNC x 7-1/2" Long
8	000-158-140	2	Nut, Hex, Nylon Lock, 5/8"-11UNC

AR - As Required NSS - Not Serviced Separately ASN - After Serial No. BSN - Before Serial No. LP - Local Purchase

PARTS ILLUSTRATIONS

Figure 4-4. Hydraulic Valve, Lift Cylinder & Related Parts

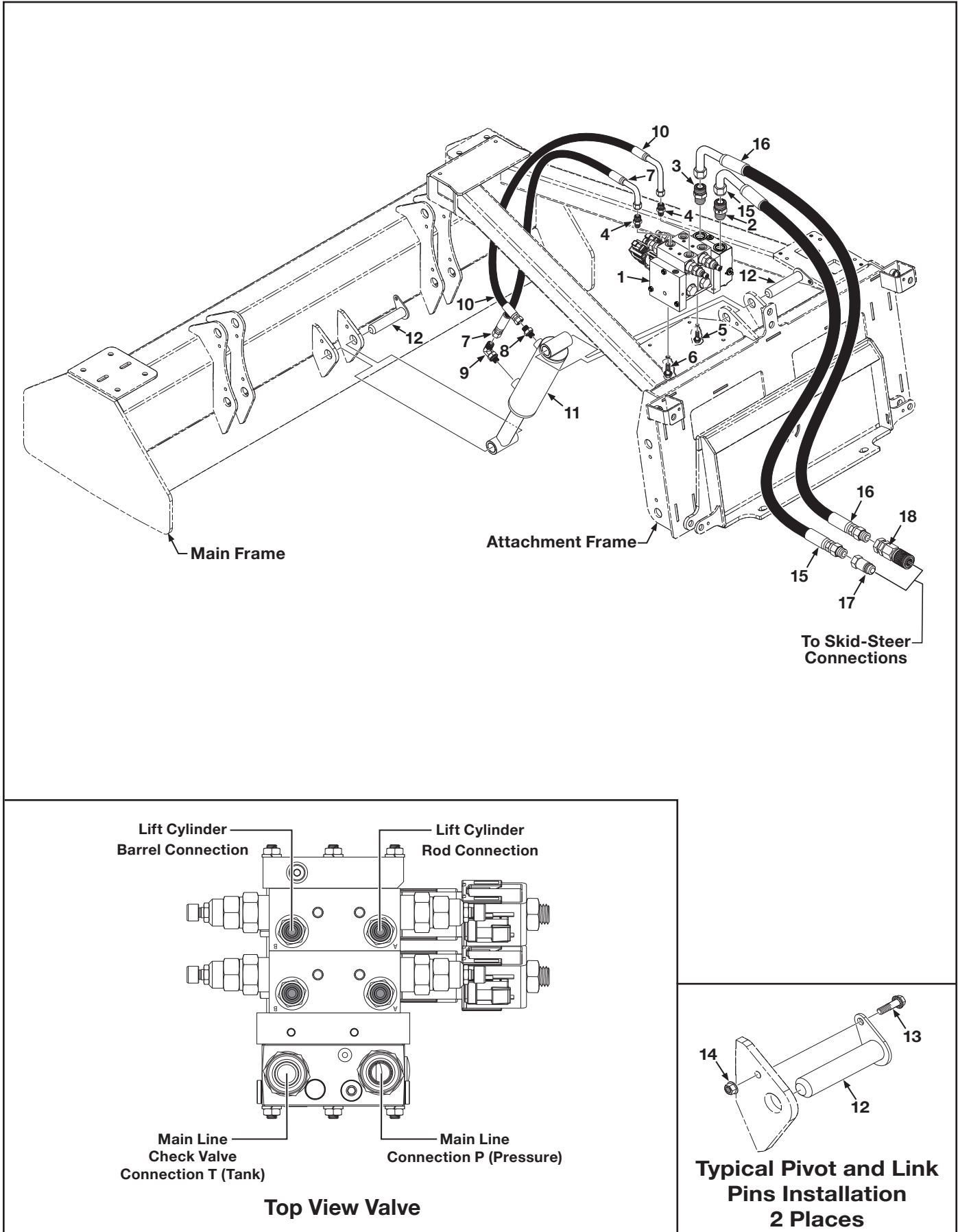

PARTS ILLUSTRATIONS

Figure 4-4. Hydraulic Valve, Lift Cylinder & Related Parts

Item	Part No.	Qty	Description
1	000-166-875	1	Valve Assembly, Hydraulic Double, Includes Items 2 thru 4, See Breakdown Figure 4-6
2	000-166-824	1	Valve, Check, 12OFS x 12MB, (DO NOT REMOVE FROM ITEM 1)
3	000-166-694	1	Fitting, Adapter, 12OFS x 12MB
4	000-166-685	4	Fitting, Adapter, 6OFS x 6MB
5	000-150-074	2	Bolt, Serrated Flange, 5/16"-18UNC x 3/4" Long
6	000-150-119	1	Bolt, Serrated Flange, 3/8"-16UNC x 3/4" Long
7	000-166-896	1	Hose, 3/8" Dia. x 29" Long x 6FFX x 6FFX90, 3,000 PSI
8	000-166-685	1	Adapter, Straight, 6OFS x 6MB
9	000-166-697	1	Elbow, 90°, 6OFS x 6MB
10	000-166-736	1	Hose, 3/8" Dia. x 26" Long x 6FJX x 6FFX90L, 3,000 PSI
11	000-166-680	1	Cylinder Assembly, Hydraulic, 2-1/2" Bore x 6" Stroke
12	000-161-168	2	Pin, 1" Dia. x 4-5/8" Long
13	000-150-074	2	Bolt, Serrated Flange, 5/16"-18UNC x 3/4" Long
14	000-158-223	2	Nut, Serrated Flange, 5/16"-18UNC
15	000-166-908	1	Hose, 5/8" Dia. x 42" Long x 10MB x 12FOFX90
16	000-166-908	1	Hose, 5/8" Dia. x 42" Long x 10MB x 12FOFX90
17	000-166-859	1	Coupler, Quick Disconnect, Flat Face, Male (Tank Line)
18	000-166-860	1	Coupler, Quick Disconnect, Flat Face, Female (Pressure Line)
			BH-Bulkhead MP-Male Pipe FP-Female Pipe FPX-Female Pipe Swivel MB-Male O-Ring Boss FB-Female O-Ring Boss MJ-Male JIC FJ-Female JIC FJX-Female JIC Swivela

AR - As Required NSS - Not Serviced Separately ASN - After Serial No. BSN - Before Serial No. LP - Local Purchase

PARTS ILLUSTRATIONS

Figure 4-5. Hydraulic Valve, Tilt Cylinder & Related Parts

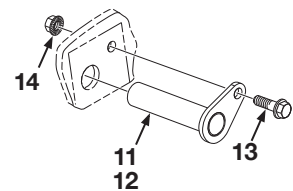
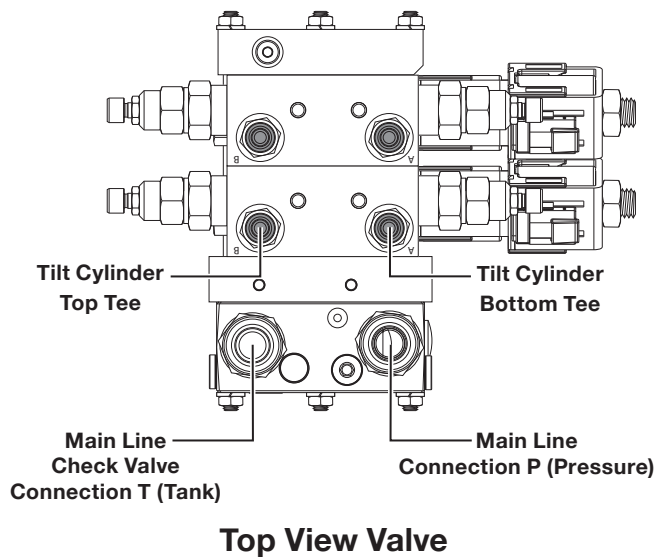
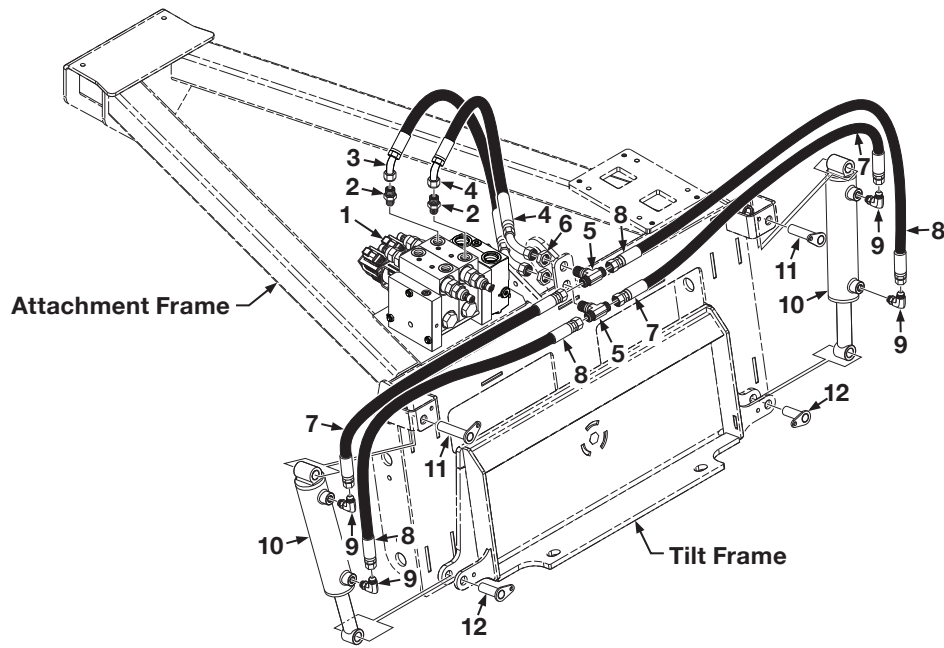

Typical Pivot and Link Pins Installation 4 Places

PARTS ILLUSTRATIONS

Figure 4-5. Hydraulic Valve, Tilt Cylinder & Related Parts

Item	Part No.	Qty	Description
1	000-166-875	1	Valve Assembly, Hydraulic Double, Includes Item 2
2	000-166-685	4	Fitting, Adapter, 6OFS x 6MB
3	000-166-907	1	Hose Assembly, 3/8" Dia x 20" Long x 6FFX45 x 6FFX45, 3,000 PSI
4	000-166-907	1	Hose Assembly, 3/8" Dia x 20" Long x 6FFX45 x 6FFX45, 3,000 PSI
5	000-166-695	2	Fitting, Tee, Bulkhead Branch, 6OFS x 6OFS x 6OFSBH, Includes Item 6
6	NSS	2	Nut, Hex, Lock
7	000-166-905	2	Hose Assembly, 1/4" Dia. x 20" Long, 4FFX x 6FFX, 3,000 PSI
8	000-166-906	2	Hose Assembly, 1/4" Dia. x 28" Long, 4FFX x 6FFX, 3,000 PSI
9	000-166-904	4	Elbow, 90°, 4OFS x 4MB
10	000-166-080	2	Cylinder, Hydraulic, 1-3/4" Bore x 6" Stroke
11	000-161-219	2	Pin, 5/8" Dia. x 3" Long
12	000-166-223	2	Pin, 5/8" Dia. x 2" Long
13	000-150-009	4	Bolt, Serrated Flange, 1/4"-20UNC x 3/4" Long
14	000-158-048	4	Nut, Lock, Flange, 1/4"-20UNC
			BH-Bulkhead MP-Male Pipe FP-Female Pipe FPX-Female Pipe Swivel FFX- Female O-Ring Flat Face Swivel MB-Male O-Ring Boss FB-Female O-Ring Boss MJ-Male JIC FJ-Female JIC FJX-Female JIC Swivel OFS-O-Ring Face Seal OFSBH-O-Ring Face Seal Bulkhead

AR - As Required NSS - Not Serviced Separately ASN - After Serial No. BSN - Before Serial No. LP - Local Purchase

PARTS ILLUSTRATIONS

Figure 4-6. Hydraulic Valve Assembly

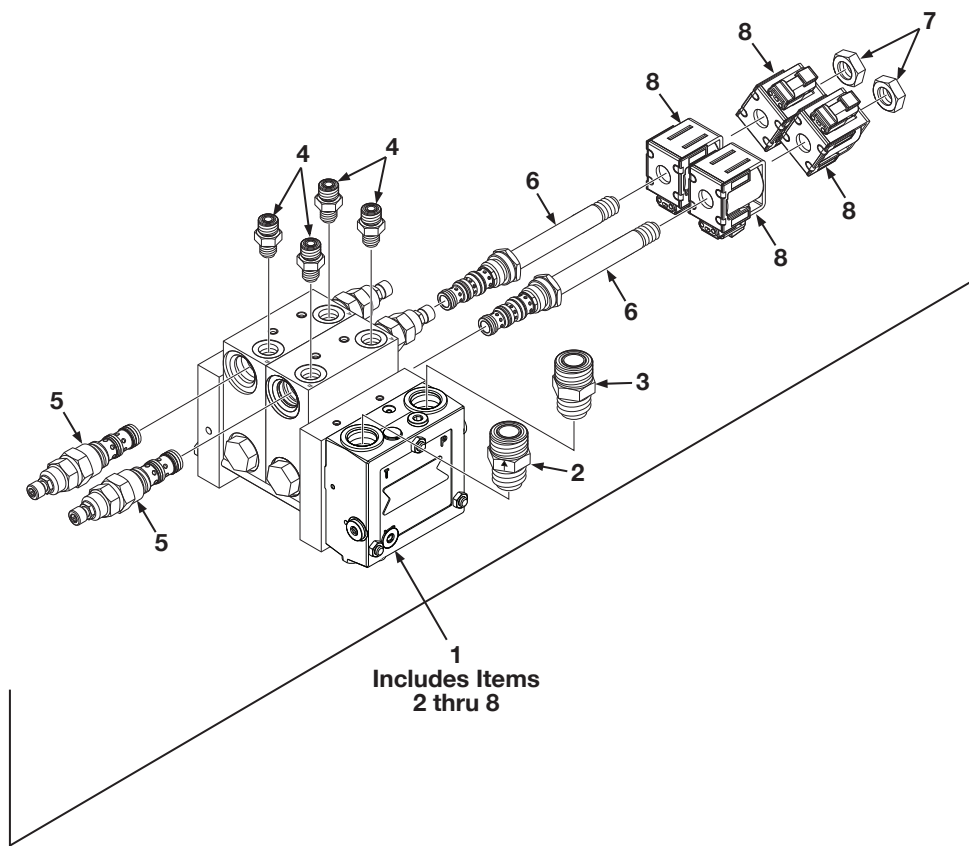

PARTS ILLUSTRATIONS

Figure 4-6. Hydraulic Valve Assembly

Item	Part No.	Qty	Description
1	000-166-875	1	Valve Assembly, Hydraulic MVB10, Includes Items 2 thru 8
2	000-166-824	1	Valve, Check, 12OFS x 12MB, (DO NOT REMOVE FROM ITEM 1)
3	000-166-694	1	Fitting, Adapter, 12OFS x 12MB
4	000-166-685	4	Fitting, Adapter, 6OFS x 6MB
5	000-166-844	4	Valve, Counter Balance
6	NSS	2	Stem, Includes Item 7
7	NSS	2	Nut
8	000-166-843	4	Coil

AR - As Required NSS - Not Serviced Separately ASN - After Serial No. BSN - Before Serial No. LP - Local Purchase

PARTS ILLUSTRATIONS

Figure 4-7. Decals

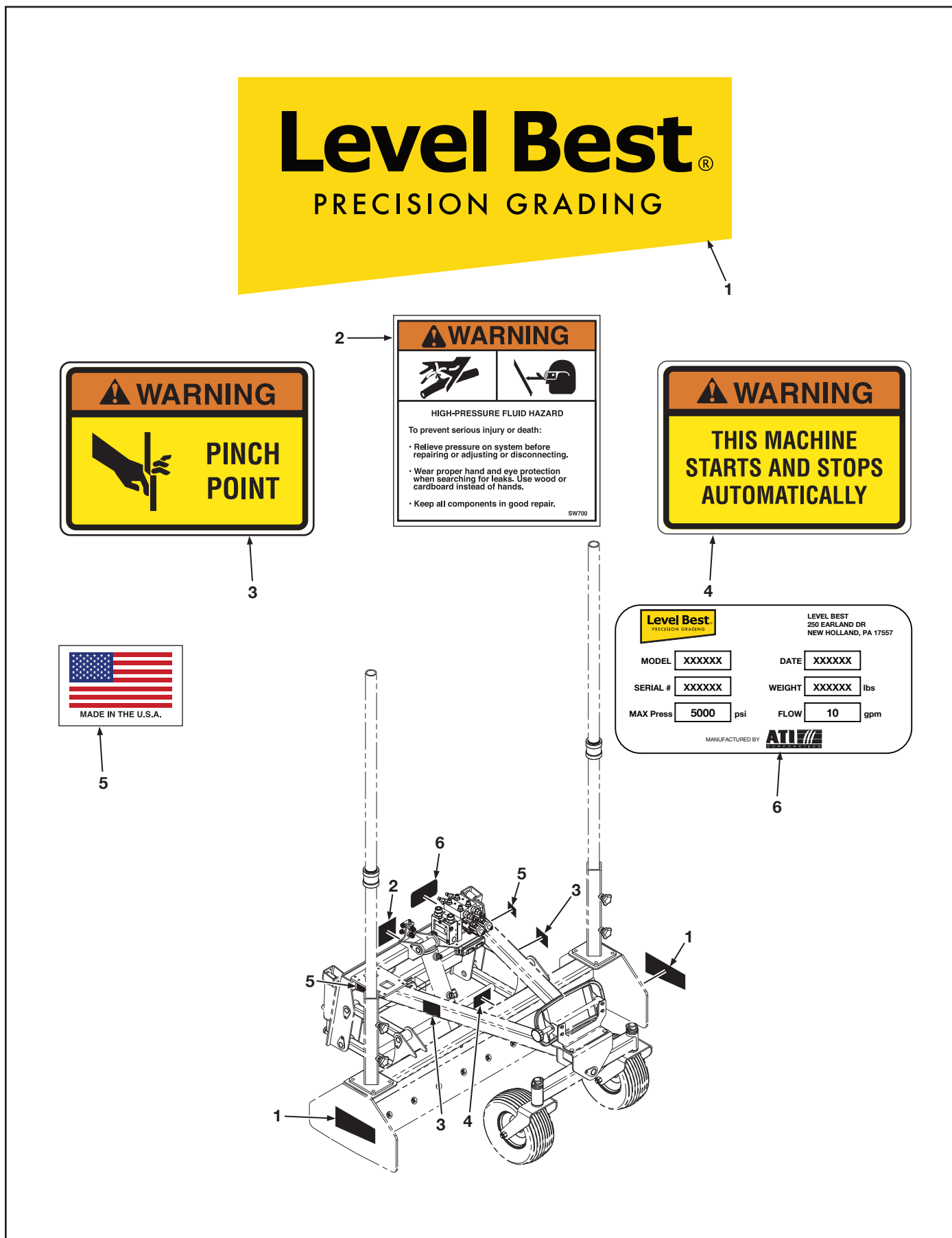

PARTS ILLUSTRATIONS

Figure 4-7. Decals

Item	Part No.	Qty	Description
1	000-186-101	2	Decal, Level Best Logo
2	000-186-041	1	Decal, Warning, High-Pressure
3	000-186-055	2	Decal, Warning, Pinch Point
4	000-186-094	1	Decal, Warning, This Machine Starts & Stops Automatically
5	000-186-092	2	Decal, Made in U.S.A.
6	000-186-111	1	Plate, Model/Serial, Adhesive Back

AR - As Required NSS - Not Serviced Separately ASN - After Serial No. BSN - Before Serial No. LP - Local Purchase

(for future use)

INDEX

A	T
Attachment Frame and Related Parts 4.6	Table of Contents iii
C	Troubleshooting 3.1
Cables and Hoses 2.1	U
Caster Fork and Wheel 4.8	Using this document i
Cleaning - Para Level 2.1	V
D	Valve Cable Connections 2.2
Danfoss MVB10 Hydraulic Valve 2.2	W
Decals 4.16	Warranty ii
Dimensions 2.1	Where To Get Parts And Service 4.2
Disclaimer i	
H	
How To Order Parts 4.2	
Hydraulics 2.2	
Hydraulic Valve Assembly 4.14	
Hydraulic Valve (Danfoss MVB10) 2.2	
Hydraulic Valve, Lift Cylinder & Related Parts 4.10	
Hydraulic Valve, Tilt Cylinder & Related Parts 4.12	
I	
Index 5.1	
J	
Joystick Functions , 1.1	
L	
List of Illustrations iv	
List of Parts Illustrations 4.3	
Loader Hydraulics 2.1	
M	
Machine - Para Level 2.1	
Main Frame and Cutting Edges 4.4	
Maintenance 2.1	
O	
Optional Joystick , 1.1	
Overview 1.1	
P	
Parts Illustrations 4.1	
PC Series Hydraulic Valve 2.1	
S	
Safety Information v	
Safety Precaution Definitions v	
Serial Number Information 4.2	
Service 2.2	
Specifications 2.1	
Specifications and Maintenance 2.1	
Storage and Transport 2.1	
Systems Features and Basic Operation 1.1	

(for future use)

